

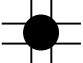
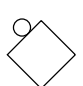
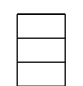
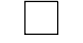

DETOUR PLAN - SB QUENTIN RD

LEGEND

-  SIGNALIZED INTERSECTION
-  48"X48" CONSTRUCTION WARNING SIGN, WITH AMBER FLASHING LIGHT NUMBER DENOTES TYPE
-  M4-9 SERIES DETOUR SIGN WITH ROAD NAME AND DIRECTION PLATES, NUMBER DENOTES TYPE
-  OTHER DETOUR SIGNS, NUMBER DENOTES TYPE
-  TYPE III BARRICADE WITH TWO AMBER FLASHING LIGHTS
-  DETOUR ROUTE

PLAN	SURVEYED	DATE
	PLOTTED	
	GRADES CHECKED	
	STRUCTURE NOTATIONS CHECKED	
	NOTE BOOK NO.	
	BY	

PROFILE	SURVEYED	DATE
	PLOTTED	
	GRADES CHECKED	
	STRUCTURE NOTATIONS CHECKED	
	NOTE BOOK NO.	
	BY	

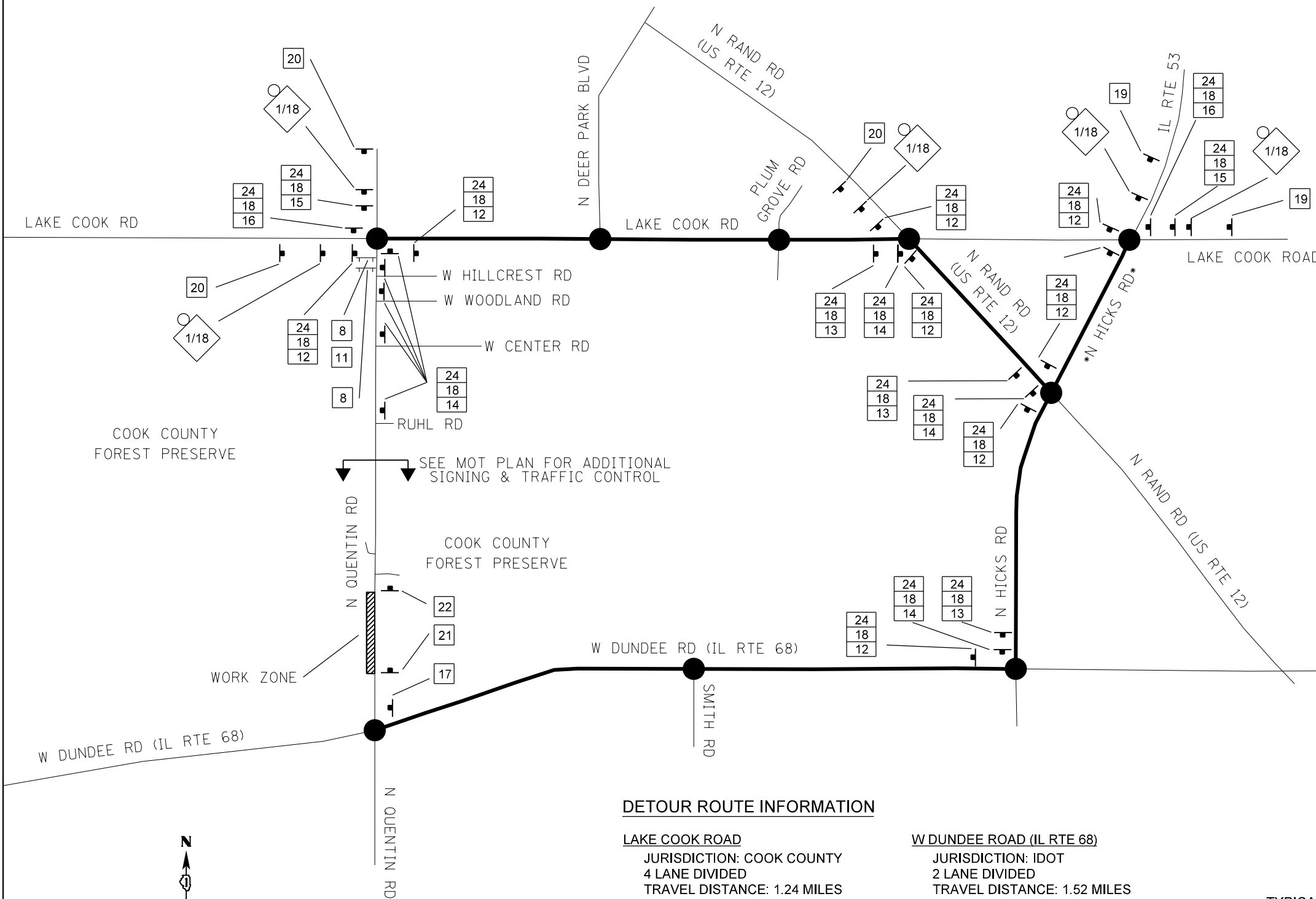

TYPICAL INTERSECTION AT POINT OF DETOUR

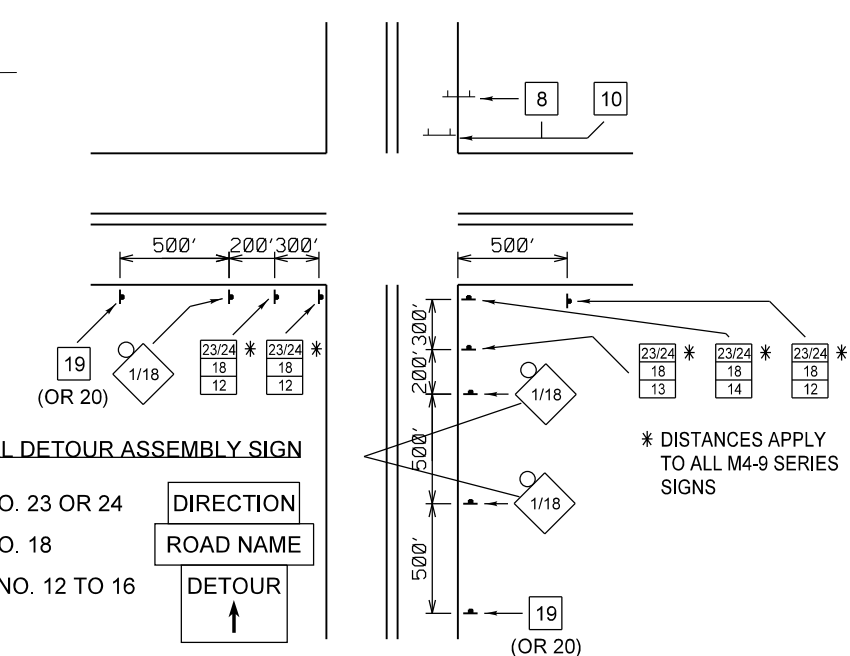

DETOUR ROUTE INFORMATION

LAKE COOK ROAD
 JURISDICTION: COOK COUNTY
 4 LANE DIVIDED
 TRAVEL DISTANCE: 1.24 MILES

N RAND ROAD (US RTE 12)
 JURISDICTION: IDOT
 4 LANE DIVIDED
 TRAVEL DISTANCE: 0.49 MILES

N HICKS ROAD
 JURISDICTION: IDOT
 4 LANE DIVIDED
 TRAVEL DISTANCE: 0.66 MILES
 (0.40 MILES)

W DUNDEE ROAD (IL RTE 68)
 JURISDICTION: IDOT
 2 LANE DIVIDED
 TRAVEL DISTANCE: 1.52 MILES

N QUENTIN ROAD
 JURISDICTION: COOK COUNTY
 2 LANE UNDIVIDED
 TRAVEL DISTANCE: 0.0 MILES
 TOTAL TRAVEL DISTANCE: 3.91 MILES

TYPICAL DETOUR ASSEMBLY SIGN

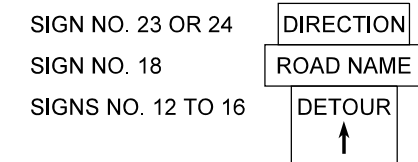

* DISTANCES APPLY TO ALL M4-9 SERIES SIGNS

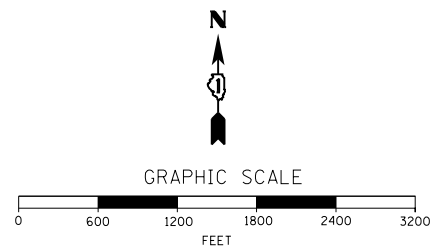

DETOUR SIGN SCHEDULE

SIGN NO.	SIGN	SIGN TYPE	QUANTITY	SIGN NO.	SIGN	SIGN TYPE	QUANTITY
①		W20-2 (O) 48	5	⑮		M4-9L (O) 3021	2
②		W20-3 (O) 48	1	⑯		M4-9L (O) 3021	2
③		W20-3 (O) 48	1	⑰		M4-8a (O) 2418	1
④		W20-3 (O) 48	0	⑱		SPECIAL (O) 9 VARIABLE	29
⑤		W21-1100 (O) 48	1	⑲		SPECIAL (O) 6030	2
⑥		R11-2 4830	2	⑳		SPECIAL (O) 6030	3
⑦		R11-3 6030	0	㉑		R6-6 (O) 2430	1
⑧		R11-4 6030	2	㉒		R6-7 (O) 2430	1
⑨		M4-8 (O) 2412	0	㉓		M3-1 (O) 2412	0
⑩		M4-10R (O) 4818	0	㉔		M3-3 (O) 2412	24
⑪		M4-10L (O) 4818	1				
⑫		M4-9 (O) 3021	9				
⑬		M4-9R (O) 3021	3				
⑭		M4-9R (O) 3021	8				

DETOUR GENERAL NOTES

- ALL SIGNING SHALL BE IN ACCORDANCE WITH THE APPLICABLE PROVISIONS OF THE STATE OF ILLINOIS "STANDARD SPECIFICATIONS FOR ROAD AND BRIDGE CONSTRUCTION ADOPTED JAN. 1, 2016", "THE QUALITY STANDARD FOR WORK ZONE TRAFFIC CONTROL DEVICES ADOPTED 2010", THE DETAILS IN THESE PLANS, THE LATEST EDITION OF THE STATE OF ILLINOIS "MANUAL OF UNIFORM TRAFFIC CONTROL DEVICES", AND THE SPECIAL PROVISIONS FOR TRAFFIC CONTROL AND PROTECTION.
- THE ENGINEER SHALL BE NOTIFIED IN WRITING AT LEAST THREE WEEKS PRIOR TO THE DAY THE DETOUR IS TO BE IN EFFECT. THE ENGINEER SHALL DETERMINE THE HOUR OF CLOSURE. THE ENGINEER WILL CONTACT THE APPROPRIATE LOCAL AGENCIES AND INTERESTED PARTIES.
- IF REQUESTED BY THE CONTRACTOR IN WRITING AT LEAST THREE WEEKS PRIOR TO THE DAY THE DETOUR IS TO BE IN EFFECT THE ENGINEER WILL FIELD LOCATE THE POSITIONS OF ANY SIGNS.
- LONGITUDINAL DIMENSIONS SHOWN ON THESE PLANS MAY BE ADJUSTED TO FIT FIELD CONDITIONS, WITH THE APPROVAL OF THE ENGINEER.
- THE ROAD SHALL NOT BE CLOSED UNTIL ALL SIGNING IS ERECTED IN ACCORDANCE WITH THE DETOUR PLAN AND INSPECTED AND APPROVED BY THE ENGINEER.
- THE CONTRACTOR SHALL BE RESPONSIBLE FOR ENSURING THAT ALL BARRICADES, SIGNS, LIGHTS, AND OTHER DEVICES INSTALLED BY HIM ARE IN PLACE AND OPERATING 24 HOURS EACH DAY INCLUDING SUNDAYS AND HOLIDAYS DURING THE TIME THE DETOUR IS IN EFFECT.
- THE TRAFFIC CONTROL SHOWN ON THE DETOUR PLAN IS THE MINIMUM NECESSARY TO ENSURE THIS ROAD CLOSURE. ALL CHANGES IN TRAFFIC CONTROL THAT ARE DEEMED NECESSARY, SHALL BE APPROVED BY THE ENGINEER.
- ALL EXISTING SIGNING THAT IS NOT APPLICABLE WHILE THE DETOUR IS IN EFFECT SHALL BE COMPLETELY COVERED BY THE CONTRACTOR, IN A MANNER APPROVED BY THE ENGINEER.
- ALL DETOUR SIGNING SHALL BE POST MOUNTED.
- ALL DETOUR SIGNING EXCEPT REGULATORY SIGNS SHALL HAVE BLACK LEGENDS WITH 6" MINIMUM LETTER HEIGHT ON FLUORESCENT ORANGE SHEETING AND STANDARD BLACK BORDERS. THE FLUORESCENT ORANGE REFLECTIVE SHEETING SHALL MEET THE REQUIREMENTS OF SECTION 1091 OF THE STANDARD SPECIFICATIONS. ALL DETOUR SIGNING SHALL BE NEW OR LIKE NEW CONDITION. THE ENGINEER SHALL BE THE SOLE JUDGE OF THE CONDITION OF THE SIGNS.
- THE SIZES OF ALL SIGNS NOT SPECIFIED IN THESE PLANS SHALL BE AS REQUIRED BY THE ILLINOIS MANUAL ON UNIFORM TRAFFIC CONTROL DEVICES.
- PRIOR TO INSTALLING POST MOUNTED SIGNS, THE CONTRACTOR SHALL CONTACT J.U.L.I.E.
- AS A MINIMUM, ALL AMBER FLASHING LIGHTS THAT ARE REQUIRED FOR THIS DETOUR SHALL MEET THE REQUIREMENTS FOR TYPE A-LOW INTENSITY FLASHING LIGHTS IN ARTICLE 1106.02 OF THE STANDARD SPECIFICATIONS. ALL LIGHTS SHALL OPERATE DURING THE HOURS OF DARKNESS. ONLY LIGHTS THAT HAVE BEEN APPROVED BY THE ILLINOIS DEPARTMENT OF TRANSPORTATION SHALL BE USED.
- WHEN REQUIRED THE MINIMUM DIMENSIONS OF THE ORANGE WARNING FLAGS SHOWN IN THESE PLANS ARE 18" X 18".
- ALL BARRICADES SHALL HAVE REFLECTORIZED STRIPING ON BOTH SIDES OF THE BARRICADES. THE TYPE III BARRICADES USED AT THE POINT OF CLOSURE TO THRU TRAFFIC SHALL NOT EXCEED 8 FEET IN WIDTH EACH, FOR A SINGLE APPROACH LANE.
- THE "ROAD CLOSED" (R11-2), THE "ROAD CLOSED XX MILES AHEAD LOCAL TRAFFIC ONLY" (R11-3) AND THE "ROAD CLOSED TO THRU TRAFFIC" (R11-4) SIGNS SHALL BE MOUNTED ABOVE THE TOP OF THE BARRICADE. ALL TYPE III BARRICADES SHALL HAVE TWO (2) AMBER TYPE A-LOW INTENSITY FLASHING LIGHTS SPACED NEAR THE CENTERLINE OF THE SUPPORTS.
- THE ROAD NAME SIGN SHALL HAVE A BLACK LEGEND ON FLUORESCENT ORANGE REFLECTIVE SHEETING. THE SIGN BLANK SHALL BE A 9" X VARIABLE OR A 12" X VARIABLE WITH DESIGN SERIES C LETTERS. THE CAPITAL LETTERS SHALL BE 6" WITH 5" LOWER CASE.
- DURING NON-WORKING HOURS AT THE POINT OF ROAD CLOSURE TO ALL TRAFFIC THE CONTRACTOR SHALL PROVIDE A MEANS TO RESTRAIN THE BARRICADES FROM EASY MOVEMENT BY VANDALS. THE CHOSEN METHOD SHALL BE APPROVED BY THE ENGINEER.
- CONSTRUCTION EQUIPMENT SHALL NOT BE PARKED IMMEDIATELY BEHIND THE TYPE III BARRICADES DURING NON-WORKING HOURS. IN ANY EVENT ARTICLE 701.04 OF THE STANDARD SPECIFICATIONS SHALL APPLY.
- THE CONTRACTOR SHALL BE RESPONSIBLE FOR MAINTAINING THE VISIBILITY OF ALL DETOUR AND CONSTRUCTION SIGNING, INCLUDING BRUSHING BACK VEGETATION IF DEEMED NECESSARY BY THE ENGINEER.
- THE FOLLOWING ILLINOIS DEPARTMENT OF TRANSPORTATION STANDARD IS APPLICABLE FOR THIS WORK:
STANDARD 701901
- THE ENGINEER SHALL BE NOTIFIED AT LEAST TWO (2) HOURS BEFORE THE ROAD IS TO BE OPENED TO TRAFFIC. THE ENGINEER WILL CONTACT THE APPROPRIATE LOCAL AGENCIES AND INTERESTED PARTIES.
- THE CONTRACTOR SHALL PLACE A PORTABLE CHANGEABLE MESSAGE SIGN ON SB QUENTIN RD AT RUHL RD TWO WEEKS IN ADVANCE OF PLANNED DETOUR TO BE PAID FOR SEPARATELY AS "CHANGEABLE MESSAGE SIGN, SPECIAL".

PLAN	SURVEYED	DATE
NOTE BOOK NO.	PLOTTED	
	CHECKED	
	FILED	
	BY	

PROFILE	SURVEYED	DATE
NOTE BOOK NO.	PLOTTED	
	CHECKED	
	FILED	
	BY	